

- 🍌 For making Rapid Dissolve Tablets.
- 🍌 96 cavities, 0.940ml / cavity
- 🍌 Typical tablet weight 0.680gm.*
- 🍌 Typical tablet diameter 13.5mm and height 6.6mm.*
- 🍌 Tamper Plate made from hard anodized aluminum
- 🍌 Cavity Plate made from Teflon coated hard anodized aluminum
- 🍌 Mold size: 330 X 235mm, Mold weight: 3.3kg.
- 🍌 Serial # marked for US DEA compliance.

***Based on the trials taken with Lactose, Sucrose and wetting agent**

Instructions

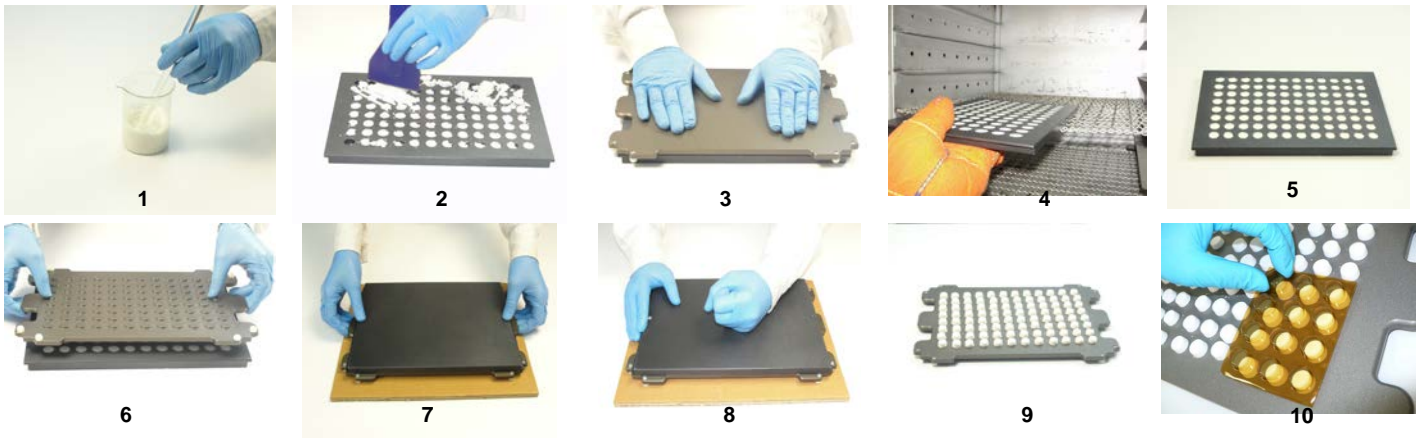

- | Photo | Instruction |
|-------|--|
| 1 | Prepare powder blend. Weight should be 96X the target weight of one tablet plus 1% extra to compensate the powder loss. |
| 2 | Spread powder blend using a rubber spatula into the cavities of Cavity Plate. Remove excess powder. |
| 3 | Press powder with Tamper Plate. Repeat steps 2 & 3 until all powder is filled in cavities. |
| 4 | Place Cavity Plate in hot air or convection oven at 110°C (230°F) for 30 minutes. |
| 5 | Remove Cavity Plate from oven & cool for 5-10 minutes at room temperature. |
| 6 | Place flat backside of Tamper Plate on top of Cavity Plate. |
| 7 | Hold both plates together and turn over so tamper pin side is down. Place on cardboard or rubber sheet to avoid the damage to tamper pins and nylon feet in next step. |
| 8 | To remove tablets, tap firmly on the back of the Cavity Plate using your fist. Tap as many times as necessary. |
| 9 | Allow tablets to rest on the back of the Tamper Plate for 15 minutes. |
| 10 | Pack all the tablets in a blister pack or similar container. Read Dissolve Tablets are more fragile than standard tablets. |

Tips

- 1 Do not use any metal object on mold as this may damage the mold.
- 2 Sept 3: If powder is not pressed hard, tablets may crumble due to air entrapment.
- 3 Step 4: Temperature should not exceed 110°C as this may degrade active ingredients.

Cleaning instructions on reverse



Cleaning Instructions:

Automatic Dishwasher Restrictions: Anodized aluminum may be cleaned in an automatic dishwasher on rinse cycle only. Automatic dishwasher detergents can discolor anodized aluminum.

Cleaning Agents: We recommend household dishwashing liquid. Do not use acidic or caustic cleaning solutions. Do not clean with abrasive cloth, gritty materials, or steel wool. Use only plastic brushes or nylon pads. Surface of anodized aluminum Teflon coating can be scratched and its non-stick properties damaged.

Isopropyl Alcohol Cleaning or Drying: May be cleaned with isopropyl alcohol. Wipe with a cloth dipped in isopropyl alcohol, then immediately wipe dry with a clean cloth.

Hot Air Drying: May be dried in a hot air oven or using a portable hair dryer.

Autoclave: Autoclave safe.



Capsule Filling Equipment



ProFiller 1100

Handheld Capsule Filler with Orienter in 100 holes. Easy to operate, up to 35% faster due to its patented design. Change parts for Sizes 000-5 and all el sizes. Output 2000-3200 capsules/hour. Order ProFill OE for AAA-D.



ProFiller 3600

300-hole hand-held filler sizes 000-4 & all el sizes. Up to 4500-6900 capsules/hour. Fits under powder hoods or in glove-box isolators. Only 300-hole hand-held system you can upgrade to a bench-top.

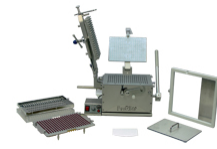

ProFiller 3700/3800

300-hole Bench-top filler sizes 000-5, 00el-2el and DBcaps[®]. Up to 6000 - 9000 capsules/hour. Optional vibrator & European style Orienter.

Other Equipment

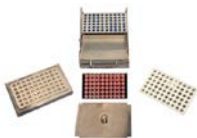

ProCoater

Enteric / Film Coat Capsule & Caplets. Enteric coat for lower intestine drug release. Film coat for taste masking or appearance.



ProMixer[™] (V-Blender)

For low shear stress powder blending in 5-10 minutes. Available with "V" or "Drum" shells. Different size shells for blending powder for batches of 60, 100, 120 or 300 capsules. Shells are in Inox (SS316) for smooth powder flow & easy cleaning.



ProFunnel

Filling funnel for precision capsule filling on a balance. Includes Tamper. Made from Inox (SS316). Available in all capsule sizes including veterinary and el sizes.

TORPAC[®]

www.torpac.com info@torpac.com
T: 1-973-244-1125 F: 1-973-244-1365
333 Route 46, Fairfield, NJ 07004, USA