

Makes 60 Animal Treats

- In 4 standard sizes: 0.93ml, 1.00ml, 1.50ml, 2.00ml.
- **Exclusive!** Tamper/Ejector Plate pins can be used to tamp treats in Mold Plate for reduced weight variation and to eject finished treats.
- **Custom sizes available.**
- Makes easy to administer medical treats for dogs, cats, and other household animals.
- Made from silver anodized aluminum with Base Plate of Inox (SS316) and Spreader of LDPE.
- Anodized parts discolor in automatic dishwashers and are engraved not for dishwasher use to prevent operator error.

Visit www.torpac.com for more information on this product

Instructions Overview

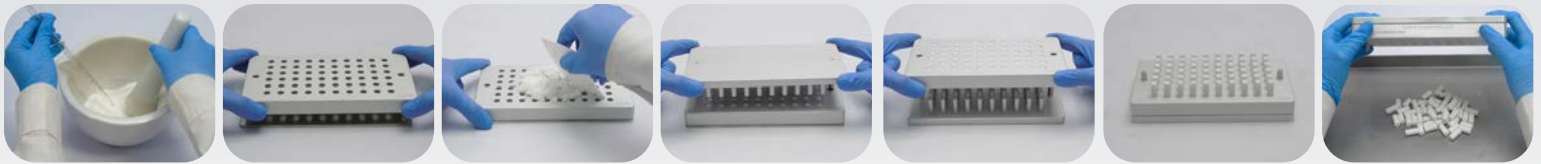

Prepare powder and add suitable wetting solution for formulation. Separate Mold Plate & Tamper/Ejector Plates. Place Mold plate on Base Plate. Place product on Mold Plate and spread filling each hole to capacity. Use Tamper/Ejector Plate to tamp and compress the product. Repeat spreading and tamping until all the product is in the holes. Place Tamper/Ejector plate on the table pin side up. Place Mold Plate on Tamper/Ejector Plate and carefully press down to eject treats. Leave both plates in place to allow treats to dry and harden. Finally turn mold over to remove treats.

Specifications & Ordering

Item #	X-MAT 60x1120	X-MAT 60x1200	X-MAT 60x1800	X-MAT 60x2400
Hole Volume	0.93 ml	1.00 ml	1.50 ml	2.00 ml
Hole Diameter	0.74" (7.95mm)	0.47" (12.00mm)	0.56" (14.20mm)	0.64" (16.40mm)
Hole Height	0.47" (18.75mm)	0.35" (9.00mm)	0.37" (9.50mm)	0.37" (9.50mm)
Treat weight*	650 mg	700 mg	1050 mg	1400 mg
Mold Dimensions inches	8.0 x 4.6 x 1.7	10.6 x 6.1 x 0.83	10.6 x 6.1 x 0.83	10.6 x 6.1 x 0.83
Mold Dimensions cms	20.3 x 11.8 x 4.4	27.0 x 15.5 x 2.1	27.0 x 15.5 x 2.1	27.0 x 15.5 x 2.1
Mold Weight	4.0 lbs (1.8kg)	6.4 lbs (3.0kg)	6.4 lbs (3.0kg)	6.4 lbs (3.0kg)
Unit Price	\$405.00	\$510.00	\$525.00	\$570.00

*based on density of 0.7 g/ml

Cleaning on reverse

ProMolds by ProFiller



Designed & Manufactured by:

TORPAC®

www.torpac.com
info37@torpac.com

US - T: +1-973-244-1125 F: +1-973-244-1365
333 US 46, Fairfield, NJ 07004, USA

EU - T: +31-6-30-93-65-27
Jan Campertstraat 19, 6416 SG Heerlen,
The Netherlands.

Cleaning

Separate all Plates before cleaning.

Automatic Dishwasher Restrictions: Anodized aluminum (both silver & hard anodized) may be cleaned in an automatic dishwasher on rinse cycle only. Automatic dishwasher detergents can discolor anodized aluminum. Inox (stainless steel) Base Plate can be cleaned in a dishwasher with detergent.

Cleaning Agents: We recommend household dishwashing liquid. Do not use acidic, caustic or abrasive cleaning materials.

Cleaning Wipes: Do not use abrasive cloth or steel wool. Use only soft cloths, sponges, plastic brushes, or nylon pads.

Isopropyl Alcohol Cleaning or Drying: May be cleaned with isopropyl alcohol. Wipe with a cloth dipped in isopropyl alcohol, then immediately wipe dry with a clean cloth.

Hot Air Drying: May be dried in a hot air oven or using a portable hair dryer

Autoclave: Metal parts are autoclave safe.



ProFiller®

Hand-Held systems in 100, 120 & 300 holes



1100



1120



3600



Bench-Top Filler
300 holes



Choose your Orienter



Hand-Held Orienter
3700 / 3700OE



European Style
Orienter 3800



Automatic
Orienter X900

Fastest & easiest to use capsule filling systems. Output from 2000-14000 capsules/hour in sizes 000-5, 00el-2el and AAA-D.

ProMixer™

Mixers from 130ml to 10L. A 3-Axis 2L manual shaker-mixer that uses rotation, translation and inversion. Motor driven mixers in two sizes and a selection of drum and V-shells.



3-Axis Mixer



750



10L



V-Shells
220ml-5L



Drum Shell
130ml-10L

ProMold™

Anodized Aluminum molds. Available in standard & custom sizes.



TTM
Tablet & Triturate



TLM
Troche & Lozenge



RDTM
Rapid Dissolve Tablet



RSM
Rocket Suppository



ATM
Animal Treat

Other Equipment



ProTRM™
Three Roll
Ointment Mill

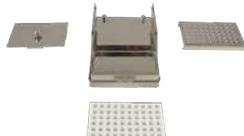

ProCoater™
For enteric film & coating
of capsules & caplets



ProFunnel™
Funnel for precision
capsule filling on a balance



ProCounters
Divide 300 capsules into
batches of 30, 60 or 100